

# J Series and Hardwood Series Installation Instructions

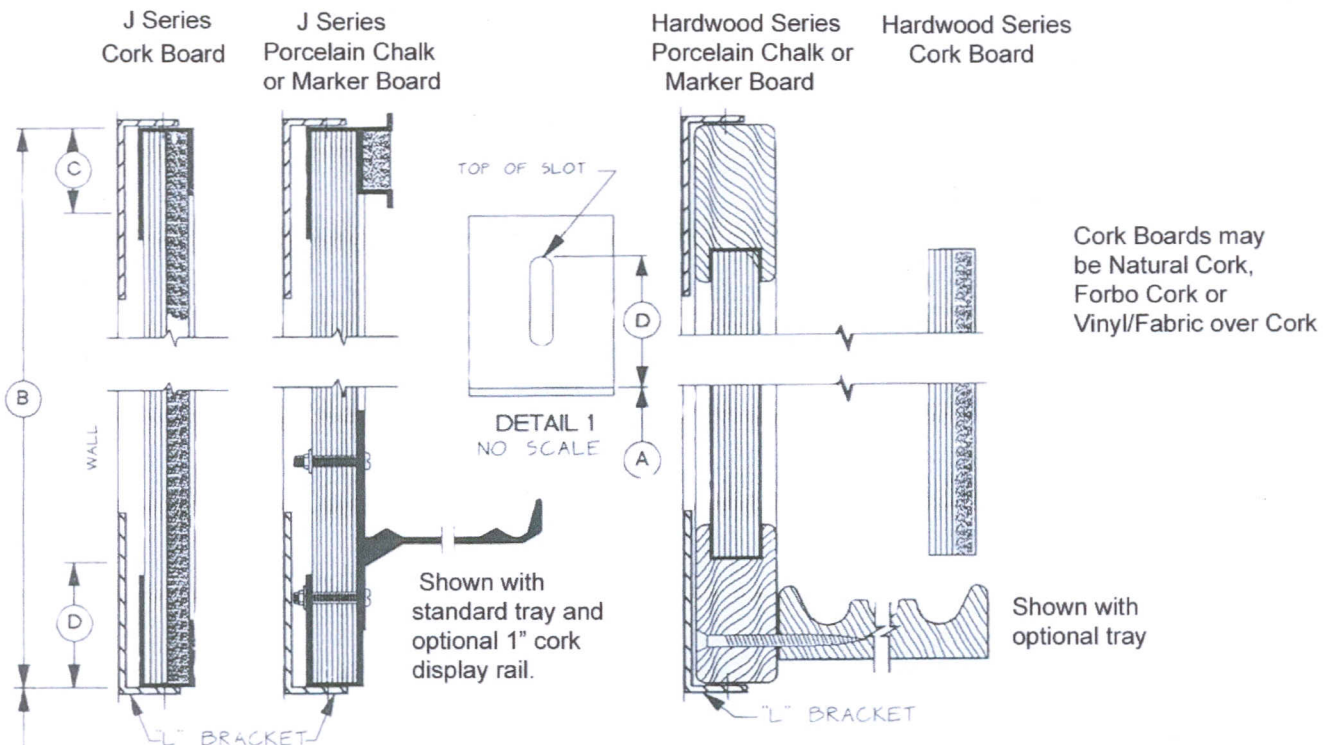

Tools Needed: Measuring Tape, Drill with Bits, Phillips Screw Driver, Hammer, Level

## Step One:

Determine the appropriate distance from the floor to the bottom of the board. This depends on the nature of the installation: A board in a conference room used by adults should be higher than a board mounted for Kindergarten students. Many boards are mounted at 36" above the floor. Snap a level chalk line (or draw a line) at the desired height. (The location at the top of dimension "A" in the drawing.)

## Step Two:

Measure from the line from step one and draw second level line to a point equal to the height of the board (Dimension "B") less 1". (At the location shown in the drawing as the bottom of dimension "C".) For example: If you are installing a standard 48" board this means the second line would be 48" less 1" = 47" above the first line. A 60" high board means that the second line would be 60" minus 1" = 59" above the first line.

## Step Three:

Mount the "L" clips on the second line (shown in the drawing as the bottom of "C") in the manner shown in the drawing. Put one at each end of the board then equally space the remaining "L" clips. It's best to mount the "L" clips directly to the studs (usually 16" "on center"). Use a screwdriver to install the included 1 1/4" #12 Phillips screws through the "L" clips and into the studs. If you are mounting on "dry wall" you can use the included plastic plugs rather than attaching directly to studs. Masonry walls require that you use "mollies" (not included) rather than plastic plugs.

## Step Four:

Attach the included slotted "L" brackets on the first line (At bottom of "D") using the included 1 1/4" #8 Phillips screws. The bottom of the "L" clips should be on the line. The screws should be at the top of the slots. Only hand-tighten since the "L" brackets may need some small movement in the slot to level the board.

## Step Five:

Have two, or more, people lift and mount the board so that the board slides firmly into the bottom "L" clips. Level the board, if needed.

## Step Six:

Press the board firmly to the wall and use a hammer to tap the top of the board into the top "L" brackets. Secure the "L" brackets to both the bottom and top edges of the board using the included #6 Phillips screws.



— Mats —  
Absolutely  
every kind!

(516) 501-0744 • Fax (516) 501-0753  
thematking.com • drew@thematking.com  
3000 Hempstead Turnpike, Suite 305 • Levittown, Long Island, NY 11756